

Featured Product:

## Floorstanding Linkboard Panel



### 500kW Generator Linkboard Panel

- Available for low voltage 12 lead gensets rated up to 1000kW
- Voltage Position Indication Lamp
- Overload and Short circuit protection is provided at each voltage position
- Lexan protective cover to allow viewing of linkboard position while preventing inadvertent contact with energized components
- Simple reconnection between high voltage mode (480V L-L / 277V L-N) and low voltage mode (240-208V L-L / 120V L-N)
- Integral Circuit Breaker complete with 24VDC Shunt trip and auxiliary contacts
- Silver plated copper bus
- Single or Dual output circuit breaker arrangements

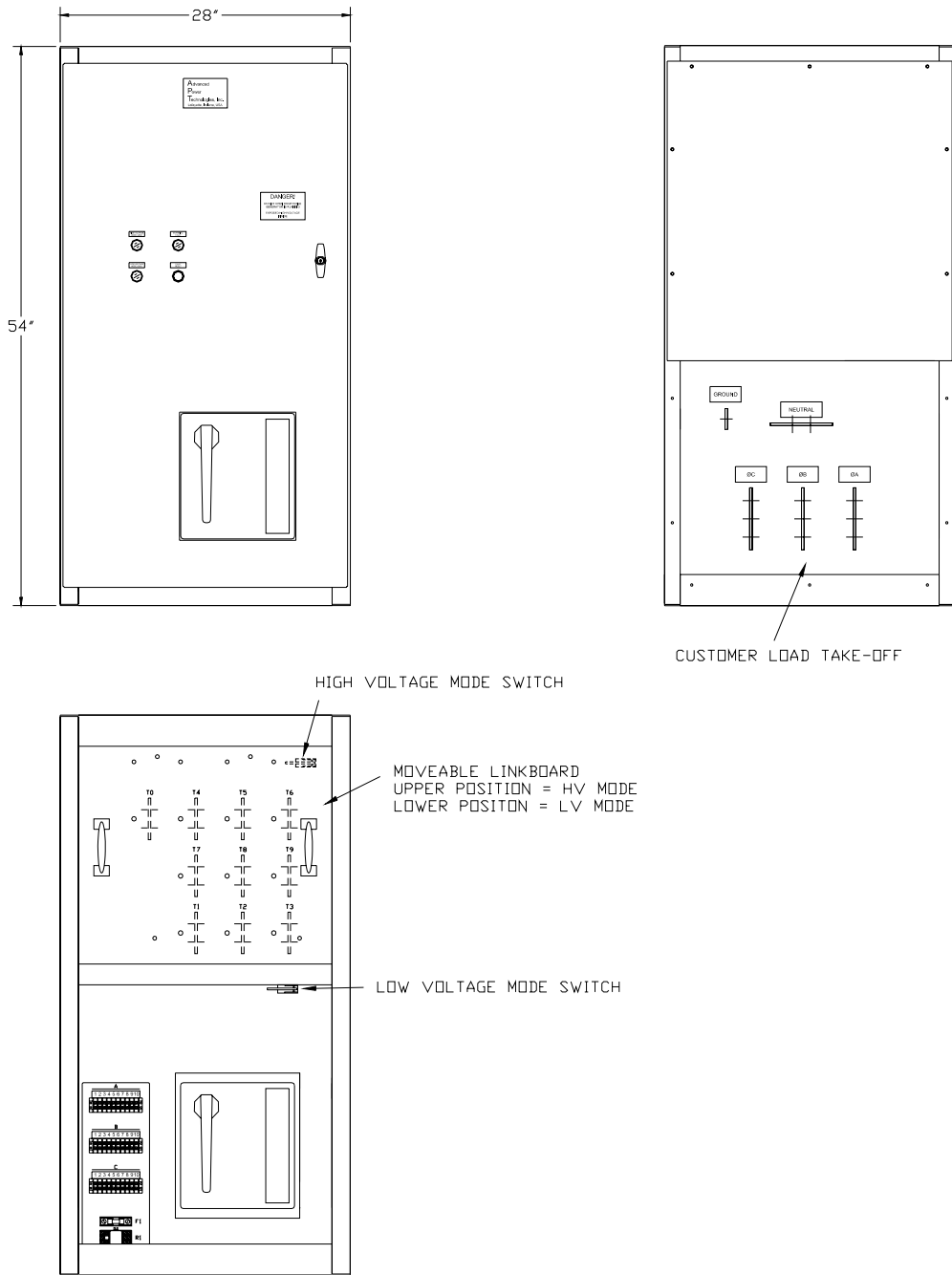

The link board provides a simplified means of reconnecting the 12 lead generator for either low voltage mode (240-208V L-L / 120V L-N) or high voltage mode (480V L-L / 277V L-N) operation. Link board consists of a base insulating board with copper bus bars installed and a movable top insulating board with various copper bus bar links installed. Voltage changeover is achieved by removing link board nuts/washers, moving the link board up or down a position as required, and then reinstalling the nuts/washers. Limit switches shall sense the link board position and illuminate a corresponding indicating lamp on the door.